

LED Ceiling Light

YS4W430
YS4W465



Features

- Color: cool white, warm white, nature white, other available
- Enclosure material: Aluminum & Acrylic
- Beam angel: 110 Degree
- Saving energy: 50%
- Lifespan more than 30 ,000 Hrs
- IP code: IP40
- Working voltage: DC 18~24V
- LED Source: SMD2835
- No UV,no IR
- Safety standard:SAA,RoHS, CE

Applications



- Hotels
- Conference / Meeting rooms
- Factories & Offices
- Commercial Purposes.
- Residential / Institution Buildings
- Schools, Colleges & Universities
- Hospitals

Dimensions (Unit: mm/inch)

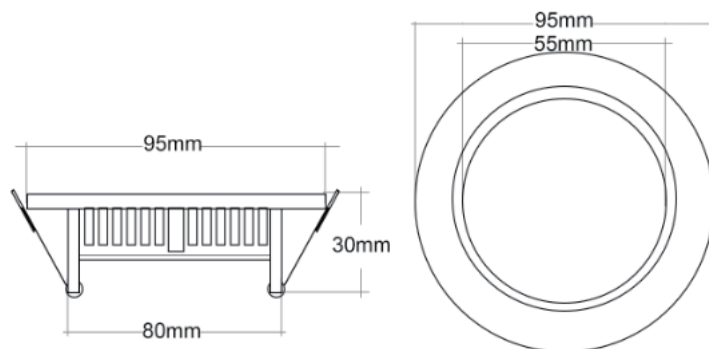

Specifications

Model #	Color	LED Type	CCT	Rated Power Consumption	Luminous Flux	Input Voltage	Beam Angle
YS4W430 YS4W465	Warm White Cool White	SMD2835	3000-3500K 6000-6500K	4W	320LM	AC85~265V	110°

Absolute Maximum Rating

Parameter	Rating	Units
Aluminum Heat sink Temperature	70	° C
Operating Temperature	-20~+40	° C
Storage Temperature	-20~+80	° C
Equilibrium Temperature	58	° C

Electrical Connection

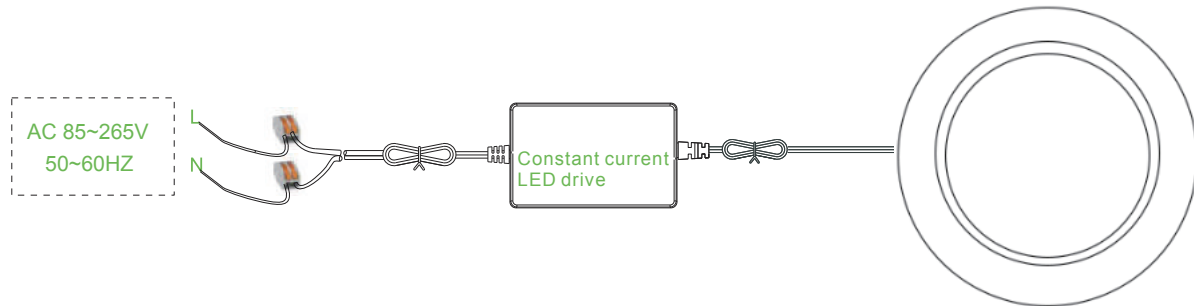

Installation Instructions

REMARKS:

Each model of LED ceiling lights has its own cut out diemension.

①	make a hole
②	connect the power wire
③	push spring
④	put the lamp into the hole

A	Wall
B	Spring
C	LED lamp
D	Driver

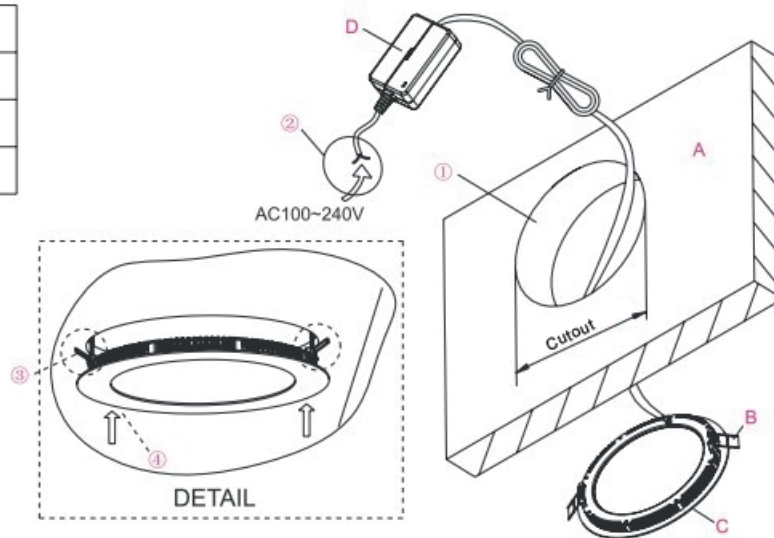

Packing Specification(mm)

- 1.All dimension units are millimeter.
- 2.50pcs inner boxes in one carton.

